

PLUS CLOSETS®

OUR SHOP IS YOUR SHOP

About PLUSCLOSETS®

OUR SHOP IS YOUR SHOP

Are you a closet company, custom home builder, kitchen and bath dealer, home remodeler or interior designer looking to add additional product lines to offer to your clients? With nearly three decades of manufacturing experience in the closet industry and 60,000 sq. ft. of facility, Plus Closets is your partner in profit.

- No franchise fees, and no marketing fees!
- Tools available to make your job easier:
 - Printed marketing materials
 - Showroom-in-a-Case
 - Access to ClosetPRO drawing software, including our product line components.
- Highest quality materials
- 3/4" furniture-grade double sided melamine
- Custom colored wood veneers
- Numerous door and drawer profiles
- Solid wood door and drawer fronts and trims
- Thermofoil door and drawer fronts and trims



At Plus Closets, Our Shop is Your Shop!

Our Team

Our professional and hard working team are the best trained and most experienced in the industry. We're here to help you succeed.

Our Promise

At Plus Closets we are dedicated to excellence. We guarantee your order will arrive complete and ready to install. If you have any issues, please do not hesitate to call.

More Than Just Closets

We make closets, pantries, garages, offices, wall beds, laundry rooms, mudrooms and more!



Our Process

Step 1: DESIGN

Use our drawing software or we draw for you!

With Plus Closets, there are two ways to design your system. The first option is to send in a sketch to us and we will draw the system based off your measurements (for a small cost); the second option is to draw the system yourself through access to ClosetPRO, including our product line components (Training available). Contact your rep for more information.



Step 2: MANUFACTURING

High quality materials and craftsmanship.

Once the design is finalized, it goes to our experienced manufacturing team to be produced on site. Plus Closets utilizes several state-of-the-art CNC and Edgebander machines to cut and shape the materials all while minimizing waste. Each piece is run through strict quality control protocols to ensure each piece is perfect.



Step 3: SHIPPING

Easy to understand, ready to install products.

At Plus Closets, we pay particular attention to packing and shipping. After the system is manufactured, each panel is labeled to correspond to the installation instructions. For shipments containing multiple projects, each package is color-coded, based on the project. Your job is then shipped in a 4x8 ft. durable wood floor skid box. Each order ships out ready-to-install within 10-15 business days of ordering (may be longer for custom orders).



Our Products

The Hardware Difference

Most hardware arrives pre-installed on Plus Closets® systems.



Undermount Birch Drawer Boxes with Soft Close Are Standard

All Plus Closets® drawer boxes are constructed from high quality Baltic Birch with dovetail joints. In addition, Plus Closets® is proud to include high-end, undermount drawer slides with soft close as our standard drawer option.

Wooden Drawer Box Highlights

- High Quality 12mm Russian Baltic Birch
- 9-Ply plywood with banded edges
- Dovetail Construction that is CNC machined for tight and strong fit
- 1/4" Birch drawer bottom
- Ultraviolet cured finish
- Environmentally friendly low VOC's and CARB II Certified
- Shipped fully assembled
- Standard Depth: 14" 16" & 20"
- Standard Width: 18" 24" 30"
- Custom widths and depths available (special order surcharge and longer lead-times)
- Drawer boxes assembled with fronts and handles

Undermount Drawer Slide Highlights

- Soft Close, 2" stroke
- Full Extension (7/8)
- Fully concealed undermount for a clean look
- Adjustable to properly align drawer faces
- 75 pound class dynamic load rating
- Hydraulic dampener allows drawers to close smoothly and quietly
- Easy to remove drawers, clean and re-install
- Passes KCMA/BIFMA/BHMA/ANSI Specifications



The 360 Organizer® Rotating Closets

Make organizing your shoes, clothing and accessories easy and convenient with the 360 Organizer®. This innovative design uses a rotating mechanism to allow for easy and quiet rotation while dramatically increasing storage space within a small 40" or 42" footprint. Available in 2 styles, It can be used either alone as a free-standing unit, or built-in as part of a comprehensive closet system. Four models are available: the Shoe Spinner, the Valet, the Double Hang and the pantry.



The 360 Organizer® FS Double Hang

- Offers two levels of hanging on the front and back, with adjustable shelving for shoes or smaller items on the sides.
- Side shelves:
28.375"W x 6.25"D (18 shelves)
- 24" wide hanging
- Requires 42" space for installation
- Overall Dimensions:
89"H x 42"W x 42"D

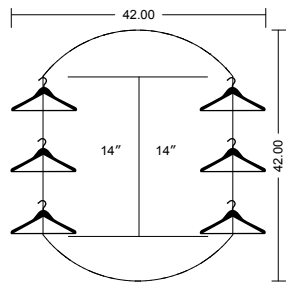

Front



Back

The 360 Organizer® FS Shoe Spinner

- Adjustable shelving maximizes the storage of shoes, purses and folded items.
- Main shelves:
24"W x 14"D (16 shelves)
- Side shelves:
28.375"W x 6.25"D (18 shelves)
- Requires a 40" space for installation
- Overall Dimensions:
89"H x 40"W x 40"D

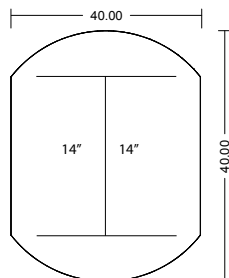

Front



Back

The 360 Organizer® FS Valet

- Allows for a combination of long hang, drawers and adjustable shelves to store a wide range of clothing, shoes and purses.
- Main shelves:
24"W x 5.875"D (8 shelves)
- Side shelves:
28.375"W x 6.25"D (18 shelves)
- Drawers: 22"D x 3"-7"H
- Requires a 40" space
- Overall Dimensions:
89"H x 40"W x 40"D

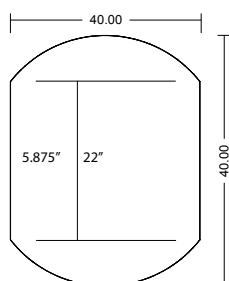

Front



Back

The 360 Organizer® Built-In Shoe Spinner

- Adjustable shelving maximizes the storage of shoes, purses and folded items.
- Main shelves: 24"W x 14"D (16 shelves)
- Side shelves: 28.375"W x 6.25"D (18 shelves)
- Requires a 40" space for installation
- Overall Dimensions: 91.5"H x 40"W x 40"D

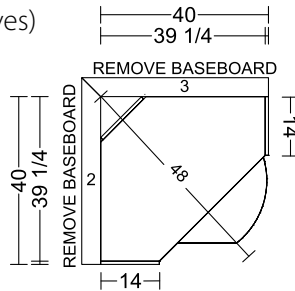

Front



Back

The 360 Organizer® Built-In Valet

- Allows for a combination of long hanging, drawers and adjustable shelves to store a wide range of clothing, shoes and purses.
- Main shelves: 24"W x 5.875"D (8 shelves)
- Side shelves: 28.375"W x 6.25"D (18 shelves)
- Drawers: 22"D x 3"-7"H
- Requires a 40" space
- Overall Dimensions: 91.5"H x 40"W x 40"D

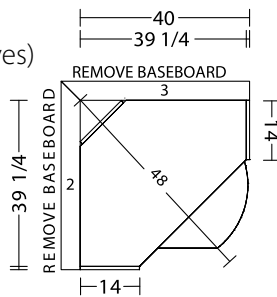

Front



Back

The 360 Organizer® Built-In Pantry

- Two versions are available for use either in a corner or along a wall. All shelves include chrome fences to ensure items stay put.
- Deep Shelves: 18"W x 14"D
- Shallow Shelves: 18"W x 4"D
- Side Shelves: 18"W x 3.5"D
- Dimensions Corner Pantry Cabinet: 84"H x 32.75"W x 32.75"D
- Dimensions Wall Pantry Cabinet: 84"H x 31.5"W x 26"D

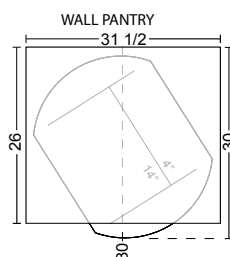
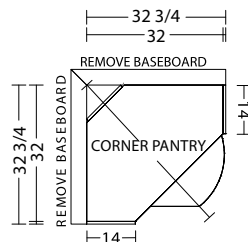

Corner



Wall

Our Quality

Product quality is our highest priority. Materials and craftsmanship are among of the ways we stand out from our competitors.



Plus Closets



Competition

1. Plus Closets uses an adjustable hanger bracket suspension system to hang suspended panels. This allows for adjustment up/down and forward/backward to accommodate walls that are not straight or square. Some of our competitors don't use suspension brackets. Panels are hung directly on the rail without any adjustability. This is often a point of system failure. Also, Plus Closets provides plastic covers to conceal suspension brackets and rail for a clean look.



2. Plus Closets uses furniture grade 3/4" thick thermally-fused laminate (Melamine) material with all exposed edges edgebanded. Many of our competitors use 5/8" material and typically don't edge band bottom of vertical panels. Over time, the thinner materials are more likely to bend, sag and distort their shape.



Plus Closets

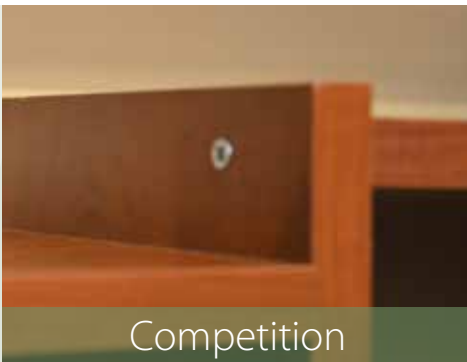

Competition

3. For fixed shelves, Plus Closets uses through-anchor construction that allows for continuous shelving at the same height. We preinstall locking cams which are easily secured to the shelf. Competitors use screws to hold shelves together which forces the shelves to be staggered to access the screws.

Dealer Benefits

At Plus Closets we pride ourselves on our Dealer's success. Here are a few of the tools available to dealers:



Support Materials:

Plus Closets provides support materials for your design and installation needs in the form of digital sell sheets, brochures, product info sheets and printed instruction manuals.



Showroom Discount:

Receive 20% off the wholesale price when you order a showroom display from Plus Closets (*Limit one discounted display for your showroom per year – subject to approval*). Submit your completed application form found on the Dealer Zone, along with your design, to your Account Representative for Approval.

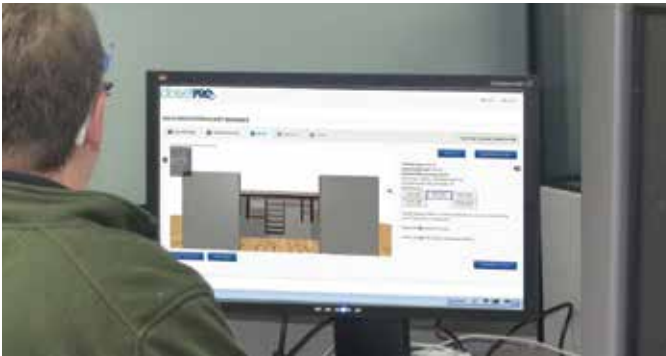

ClosetPRO:

ClosetPRO Software is a responsive, web-based closet design tool that allows you to quickly and accurately build and price a closet from any device, and then view it immediately in 3D. It is intended for our dealers who need a simple, yet powerful, front end tool for their salespeople to use.

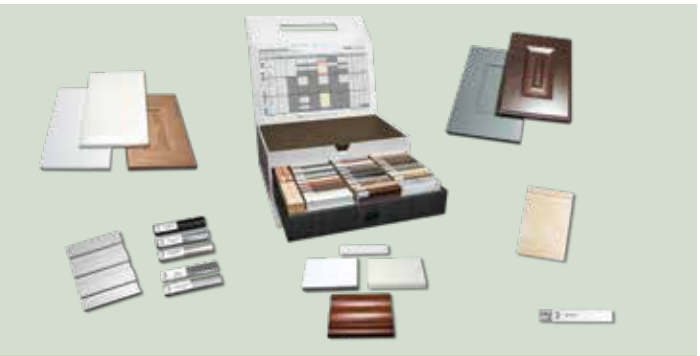

Color Sample Box & Showroom-in-a-Case:

The Showroom-in-a-Case is the best sales tool available to Plus Closets dealers. It includes the color sample box with samples of all of our laminates to allow customers to see and touch available colors, three different veneers and a MDF sample. Also included are metal finish samples, door and drawer profiles, crown and base moulding, & more.



Unbranded Catalogs:

Plus Closets offers our dealers printed catalogs that are unbranded. Personalize the cover with your company information to create your own marketing piece, or simply staple your business card to the cover and you're ready to go.



Photo Library:

Plus Closets offers our dealers a library of high resolution images suitable for print and web applications that represent the organization systems we manufacture and associated accessories.

COLOR OPTIONS: THERMALLY FUSED LAMINATES

BASE/GROUP 1 – *Base priced same as white*



GROUP 2 – *5% over white*

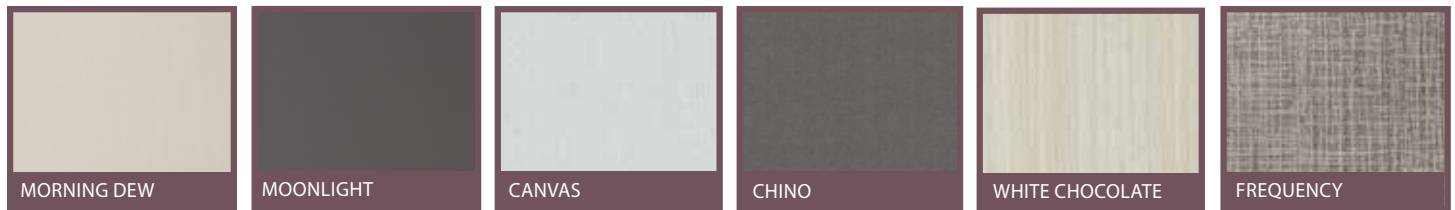

GROUP 3 – *10% over white*



GROUP 4 – *20% over white*

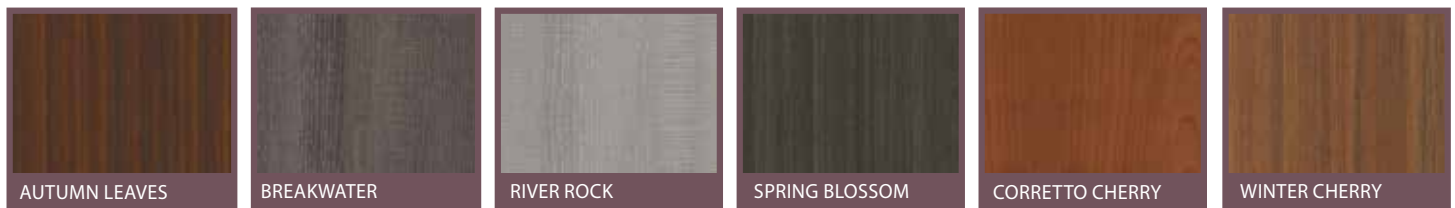

VIVA™ Laminates – The True Touch of Wood™



Ultra High Gloss



Door & Drawer Styles

Standard



MELAMINE

Edge Banded – All Sides
Standard Melamine doors and drawers are available in every color, including Chino, Frequency, Canvas and all Stylelite High Gloss finishes.

Pillow Edge



ITALIA – Pillow Bevel

Beveled Edge Series



ELEGANTE – Designer Bevel



ASPEN – Available solid or open frame



HARMONY – New Raised Panel Available solid or open frame

5 Piece Laminate Series



VILLA – Available solid or open frame



TUSCANY – Available solid or open frame



BELLA – Available solid or open frame

Eased Edge Series



CONTEMPO



SHAKER ELITE – Bead Board



SHAKER MISSION – Available solid or open frame



REGAL – Available solid or open frame

Solid Wood Series



CROWNPOINT – Available solid or open frame



UNITY – Available solid or open frame



LOWLAND – Available solid or open frame

Door/Drawer Colors & Inserts



CLEAR – 1/4" thick glass



WHITE LAMI – 1/4" thick glass



GRAY LAMI – 1/4" thick glass



BRONZE LAMI – 1/4" thick glass



REEDED – 5/32" thick clear glass with fluted texture



RAIN – 3/16" thick clear textured glass



MIRROR – 1/4" thick glass . All mirror doors include backer except for 5-piece laminate doors



MESH – Cloth for speakers and audio equipment

* Only open frame door styles can accept inserts.

COLOR OPTIONS: DOOR & DRAWER STYLES

Thermofoil Colors:

Thermo foil doors in the Pillow Bevel, Beveled Edge, and Eased Edge series profiles are available in all colors except Chino, Frequency, Canvas and High Gloss finishes unless noted. Coordinating mouldings and trim are also available.

Standard Melamine Colors:

Standard melamine door/drawer fronts are available in all laminate colors. This is the only door/drawer style available in the Ultra High Gloss laminate finish.

5 Piece Laminate Colors:

Villa: White, Vintage, Cocoa, Ginger Root, Cocoa Bean, Haze, White Chocolate, Spring Blossom, Autumn Leaves, Blackwood.

Tuscany: Ivory, White, Cocoa.

Bella: White, Breakwater, River Rock, Summer Breeze, White Chocolate, Vintage, and all VIVA™ laminates.

Solid Wood Series Colors:

The solid wood door series is available pre-finished in White, Black, Ivory, Cocoa, Moonlight, Morning Dew and Rain Cloud colors. Doors can also be ordered unfinished. They can be custom stained or painted (*additional charges will apply - see your Rep for details*).

Solid wood doors, drawer faces and mouldings feature the natural beauty of real woods. Part of the beauty comes from the irregularities in color and grain. Thus, variations among component parts are to be expected. Wood finishes are fragile and require the same care as any wood furniture.

NOTE: Photos are a representation only — request a sample for accurate color and profile detail.

Become a dealer today! Call 866-826-7587

06-2019